



## VRLA Rechargeable Battery

# MSB-1500 (2V, 1500Ah)



### FEATURES

- Sealed structure, no electrolyte leakage or spill.
- High performance alloy to secure corrosion-proof feature.
- Unique electrolyte system achieves maximum service life.
- Low self-discharge rate, lower than 3% capacity loss per month.
- Special paste formula promotes the good charging acceptance.
- Electrolyte with gel technology.

### APPLICATION

- Telecom
- UPS
- Central Office
- Energy Storage Systems



### SPECIFICATIONS

Nominal Voltage	2 V
Nominal Capacity	1500Ah @ 10 hour rate F.V.(1.80V/cell)
Approx. Weight	128.0Kg(282.2lbs.)
Terminals	B6 (Fitting M8 bolt & nut)
Internal Resistance	≤ 0.4m Ω (Fully Charged )
Max. Discharge Current	6000 A (5 sec.)
Max. Charge Current	375 A
Operating Temperature Range	Charge : 0°C~40°C(32°F~104°F) Discharge : -20°C~50°C(-4°F~122°F) Storage : -20°C~40°C(-4°F~104°F)
Safety Valve	Opening pressure 10~35 kPa
Container Material	Standard: ABS( UL 94-HB) MSB-1500 Optional: Flame Retardant ABS(UL 94-V0) MSB-1500FR



- IEC60896-21/22
- JIS C 8704-2
- GB/T19638.2
- YD/T799

### DIMENSION(mm/inch)

### OUTER DIMENSIONS

### TERMINAL TYPE

#### Length

400±2.0 (15.75±0.08)

#### Width

350±2.0 (13.78±0.08)

#### Container Height

341±2.0 (13.43±0.08)

#### Total Height

369±2.0 (14.53±0.08)

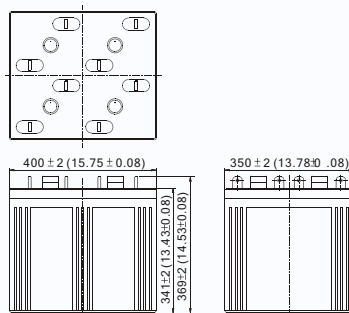

#### Terminal B6

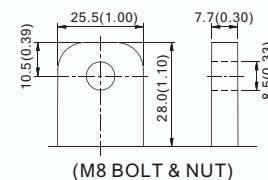

(M8 BOLT & NUT)

Terminal Hardware Initial Torque: 10.0 Nm ± 5%

### Constant power discharge characteristics at 25 °C/77 °F Unit: W

F.V. (V/cell)	Discharge Time	30 Min	1 Hr	2 Hr	3 Hr	4 Hr	5 Hr	6 Hr	8 Hr	10 Hr	12 Hr	20 Hr
1.85V		1967.3	1350.0	868.5	676.4	525.8	453.0	403.5	333.8	279.0	241.80	150.66
1.80V		2182.5	1485.0	937.5	716.6	579.0	493.5	429.8	357.0	295.3	253.47	157.99
1.75V		2391.0	1575.0	993.8	754.5	606.6	516.0	448.5	368.3	308.4	262.16	162.69
1.70V		2625.0	1680.0	1027.5	780.2	618.8	528.8	459.8	375.8	318.8	268.28	165.38
1.65V		2820.0	1732.5	1042.5	796.1	631.5	536.3	468.8	382.5	323.3	272.07	166.77
1.60V		2876.3	1747.5	1057.5	803.7	639.0	543.8	471.0	387.0	326.3	273.33	167.25

### Constant current discharge characteristics at 25 °C/77 °F Unit: A

F.V. (V/cell)	Discharge Time	30 Min	1 Hr	2 Hr	3 Hr	4 Hr	5 Hr	6 Hr	8 Hr	10 Hr	12 Hr	20 Hr
1.85V		1050.0	720.0	457.5	353.7	277.5	234.8	202.5	165.0	140.3	121.55	75.74
1.80V		1170.0	795.0	495.0	375.0	306.0	255.0	217.5	181.5	150.0	128.75	80.25
1.75V		1292.3	847.5	527.3	397.1	321.0	270.0	232.5	189.8	158.3	134.51	83.48
1.70V		1432.5	909.0	549.8	413.8	329.3	279.0	240.0	196.5	164.3	138.24	85.88
1.65V		1533.8	945.8	564.8	427.6	337.5	286.5	249.0	202.5	167.3	140.02	87.00
1.60V		1612.5	969.8	581.3	436.8	343.5	291.0	251.3	206.3	168.8	141.33	87.23

All data and artworks shall be changed without prior notice, BB reserves the right to explain and update the information contained hereinto.