



Maintenance-Free Rechargeable Sealed Lead-Acid Battery



BTX20A-SLA

The battery is constructed by plates, separators, safety valves and container. Since the electrolyte is held by a glass-mat separator and plates, the battery is maintenance-free, Vibration-proof. Superior dry-charged performance, More than one year storage in the drystate. Long service life.

PERFORMANCE SPECIFICATIONS

Nominal Voltage(V).....	12 volts(6cells in series)
Nominal Capacity(AH)	
10 Hour rate(F.V. 1.75V/cell) (1800mA to 10.50Volts)	18.0AH(AT 20°C/68°F)
2 Min rate(F.V.1.00V/cell) (150A to 6.0Volts).....	5.0AH(AT -10°C/14°F)
Approximate Weight(Dry/Wet).....	5350g(11.80lbs) / 6500g(14.33lbs)
Terminal	
Standard.....	Type C
Internal Resistance (Fully Charged Battery).....	<8m Ω
Maximum Discharge Current For 5 sec. (A).....	450A
Maximum Charge Current(A).....	9.0A
Cold Cranking Amps(-18°C/0°F).....	270A
Ambient Temperature	
Charge.....	0°C(32°F)~40°C(104°F)
Discharge.....	-20°C(-4°F)~50°C(122°F)
storage.....	-20°C(-4°F)~40°C(104°F)
Vibration test:	
Direction of vibration : Simple harmonic motion in up and down.	
Acceleration of vibration : 68.6 m/s ²	
Frequency of vibration : The frequency is increased from 50 Hz to 500 Hz and decreased	
From 500 Hz to 50 Hz continuously at a constant rate.	
The time required for this sweeping Cycle shall be 10 min.	
Duration of vibration : 2 hr	
The battery have no abnormality.	
Case.....	PP
Dimension(mm/inch)	
Length ±1.5mm.....	175/6.89
Width ±1.5mm.....	87/3.43
Container Height ±1.5mm.....	155/6.10
Total Height ±2mm.....	155/6.10
Application of Motorcycles Brand.....	Honda GL1800Gold Wing(1800C.C), Yamaha XV1600 Road Star(1600C.C),

BTX20A-SLA Battery Discharge Characteristics

Note : C=10HR Nominal Capacity (AH)

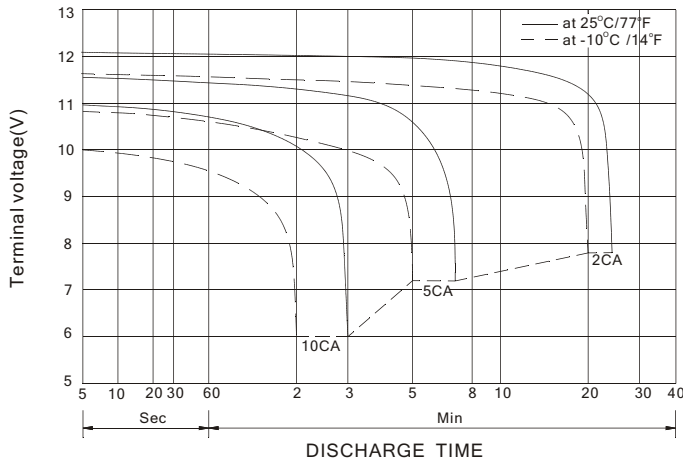

CHARGING CHARACTERISTICS

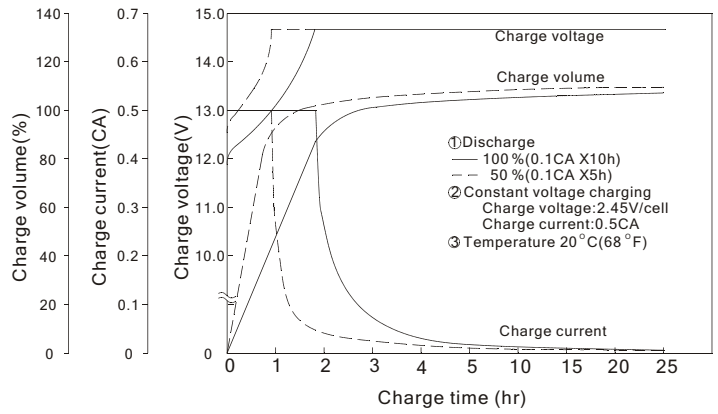

Cycle Life at High Rate Discharge

Testing Conditions : Discharge Current : 10CA(180A)
 Discharge Time : 30 Second
 Constant Voltage Charge : 2.45V/Cell
 Charge Current : 0.5CA(9.0A)
 Charge Time : 2 Hour
 Ambient Temperature : 25°C(77°F)

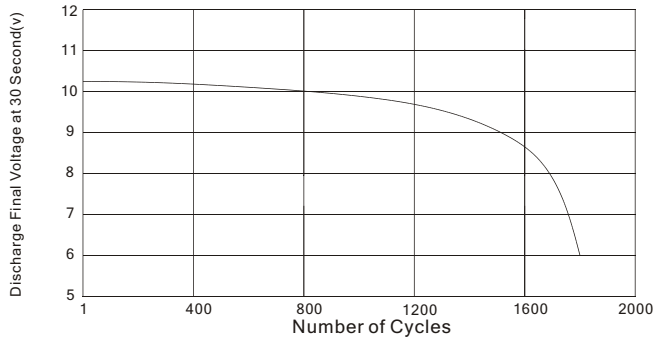

OPEN CIRCUIT VOLTAGE VS REMAINING CAPACITY

AT 20°C(68°F)

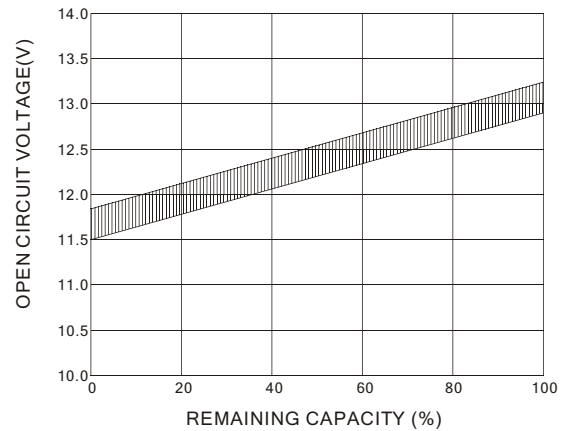

OUTER DIMENSIONS

mm(inch)

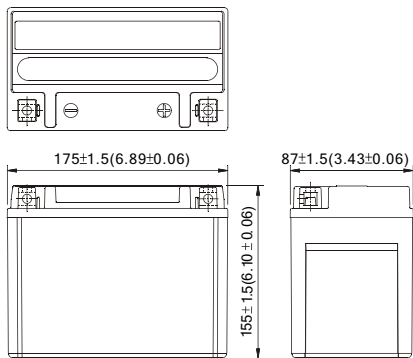

TERMINAL TYPE

mm(inch)

• C Type

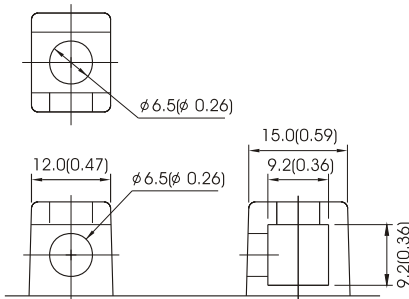

TERMINAL POSITION



B.B. BATTERY CO., LTD.

Web Site: <http://www.bb-battery.com>

USA:
 B&B BATTERY(USA) INC.
 6415 RANDOLPH ST.COMMERCE,
 CA,90040 U.S.A.
 TEL:1-323-278-1900.1-800-278-8599
 FAX:1-323-278-1268
 E-Mail:sales@bb-battery.com

EUROPE:
 B&B BATTERY(EUROPE) B.V.
 3 WIJNGAARDVELD, 9300 AALST,BELGIUM
 TEL:(00)32-53781567
 FAX:(00)32-53781567
 E-Mail:hansdevriese@bb-battery.com

CHINA FACTORY:
 B.B. BATTERY CO., LTD.
 CHENG DONG TRIAL AREA.HUANG GANG,
 RAOPING, GUANG DONG,CHINA,515700
 TEL:86-768-7601001-2
 FAX:86-768-7601469
 E-Mail:maggy@bb-battery.com

HONG KONG:
 NATIONAL TRADING LTD.
 TEL:852-2301-3800
 FAX:852-2739-1182
 E-Mail:bbhk@hkstar.com

JAPAN:
 B&B BATTERY(JAPAN) CO., LTD.
 1375-11 NARAHARA-MACHI,HACHIOJI,
 TOKYO 193-0803,JAPAN.
 TEL:81-426-256-537
 FAX:81-426-256-537
 E-Mail:miyata@bb-battery.com

TAIWAN:
 B.B. BATTERY(TAIWAN) CO., LTD.
 TEL:886-6-502-5150
 FAX:886-6-589-8087
 E-Mail:maggy@bb-battery.com



MH19884

