



VRLA Rechargeable Battery

FTB100-12 (FTB100-12FR)

(central gassing)



FEATURES

- Absorbent Glass Mat technology for efficient gas recombination
- Front accessible terminal for ease of assembly
- Carry handles for ease of installation
- Strengthened rib design to maintain structural integrity
- Flame-arrestor is installed to ensure safety
- One-way self-resealing safety valve for long life guarantee

APPLICATION

- Telecom
- UPS
- Broadband
- Electric Utility
- Railroad Signal
- Central Office



SPECIFICATIONS

| | |
|-----------------------------|--|
| Nominal Voltage | 12 V |
| Nominal Capacity | 100Ah @ 8 hour rate F.V.(1.75V/cell) |
| Approx. Weight | 36.8Kg(81.13lbs.) |
| Terminals | I2 (M6 Female Thread) |
| Internal Resistance | ≤ 3.5m Ω (Fully Charged) |
| Max. Discharge Current | 800 A (5 sec.) |
| Max. Charge Current | 25 A |
| Operating Temperature Range | Charge : 0°C~40°C(32°F~104°F) Discharge : -20°C~50°C(-4°F~122°F) Storage. : -20°C~40°C(-4°F~104°F) |
| Safety Valve | Opening pressure 10~35 kPa |
| Container Material | ABS(UL94-HB, UL94-V0 is optional) |

| | |
|---|--|
| ISO 9001 | |
| ISO14001 | |
| UL | |
| CE | |
| <ul style="list-style-type: none"> ● IEC60896 ● BS6290/4 ● GB/T 19638 ● Eurobat guide | |

DIMENSION(mm/inch)

OUTER DIMENSIONS

TERMINAL TYPE

Length

394±2.0 (15.51±0.08)

Width

110±2.0 (4.33±0.08)

Container Height

287±2.0 (11.30±0.08)

Total Height

287±2.0 (11.30±0.08)

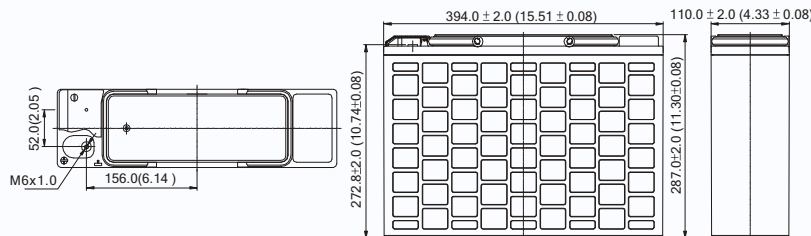

Terminal I2

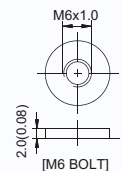

Terminal Hardware Initial Torque:
5.5Nm ±5%

Constant power discharge characteristics at 25 °C/77 °F Unit: W

| Discharge Time F.V. (V/cell) | 30 Min | 45 Min | 1 Hr | 2 Hr | 3 Hr | 4 Hr | 5 Hr | 8 Hr | 10 Hr | 20 Hr |
|---------------------------------|--------|--------|-------|-------|-------|-------|-------|--------|--------|-------|
| 1.90V | 1114 | 814 | 647.4 | 394.3 | 293.3 | 232.4 | 194.2 | 132.00 | 107.67 | 57.16 |
| 1.85V | 1226 | 889 | 719.9 | 434.1 | 320.5 | 254.2 | 211.6 | 142.82 | 117.05 | 62.18 |
| 1.80V | 1302 | 939 | 760.5 | 451.4 | 332.4 | 262.9 | 218.2 | 147.55 | 121.20 | 64.36 |
| 1.75V | 1351 | 971 | 778.6 | 459.9 | 336.7 | 267.3 | 222.5 | 150.00 | 122.40 | 65.45 |
| 1.70V | 1381 | 990 | 791.5 | 464.3 | 340.0 | 269.5 | 223.6 | 150.00 | 122.40 | 65.45 |
| 1.65V | 1401 | 1003 | 802.2 | 468.5 | 343.3 | 271.6 | 224.7 | 150.00 | 122.40 | 65.45 |

Constant current discharge characteristics at 25 °C/77 °F Unit: A

| Discharge Time F.V. (V/cell) | 30 Min | 45 Min | 1 Hr | 2 Hr | 3 Hr | 4 Hr | 5 Hr | 8 Hr | 10 Hr | 20 Hr |
|---------------------------------|--------|--------|-------|-------|-------|-------|-------|-------|-------|-------|
| 1.90V | 92.9 | 67.8 | 55.09 | 33.27 | 24.55 | 19.36 | 16.18 | 11.00 | 8.97 | 4.76 |
| 1.85V | 103.2 | 74.6 | 61.27 | 36.64 | 26.82 | 21.18 | 17.64 | 11.90 | 9.75 | 5.18 |
| 1.80V | 110.4 | 79.2 | 64.73 | 38.09 | 27.82 | 21.91 | 18.18 | 12.30 | 10.10 | 5.36 |
| 1.75V | 114.5 | 81.9 | 66.27 | 38.82 | 28.18 | 22.27 | 18.55 | 12.50 | 10.20 | 5.45 |
| 1.70V | 117.1 | 83.5 | 67.36 | 39.18 | 28.45 | 22.45 | 18.64 | 12.50 | 10.20 | 5.45 |
| 1.65V | 118.8 | 84.6 | 68.27 | 39.55 | 28.73 | 22.64 | 18.73 | 12.50 | 10.20 | 5.45 |

All data shall be changed without prior notice, BB reserves the right to explain and update the information contained hereinto.