

VRLA Rechargeable Battery

FTB100-12 (central gassing)



FEATURES

- Absorbent Glass Mat technology for efficient gas recombination
- Front accessible terminal for ease of assembly
- Carry handles for ease of installation
- Strengthened rib design to maintain structural integrity
- Flame-arrestor is installed to ensure safety
- One-way self-resealing safety valve for long life guarantee
- Battery design allows for 48VDC configuration in a standard 19" rack

APPLICATIONS

- Telecom
- UPS
- Broadband
- Electric Utility
- Railroad Signal
- Central Office



SPECIFICATIONS

Nominal Voltage	12 V
Nominal Capacity	100Ah @ 8 hour rate F.V.(1.75V/cell)
Approx. Weight	36.8Kg(81.13lbs.)
Terminals	I2 (M6 Female Thread)
Internal Resistance	≤ 3.5m Ω (Fully Charged)
Max. Discharge Current	800 A (5 sec.)
Max. Charge Current	25 A
Operating Temperature Range	Charge 0°C~40°C(32°F~104°F) Discharge -20°C~50°C(-4°F~122°F) Storage. -20°C~40°C(-4°F~104°F)
Safety Valve	Opening pressure 10~35 kPa
Container Material	Standard: ABS(UL94 HB) FTB100-12 Optional: Flame Retardant ABS(UL94 V-0) FTB100-12FR



- IEC60896
- BS6290/4
- GB/T 19638
- Eurobat guide

DIMENSION(mm/inch)

OUTER DIMENSIONS

TERMINAL TYPE

Length

394±2.0 (15.51±0.08)

Width

110±2.0 (4.33±0.08)

Container Height

287±2.0 (11.30±0.08)

Total Height

287±2.0 (11.30±0.08)

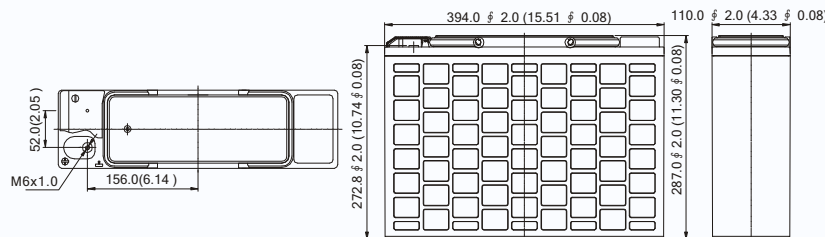

Terminal I2

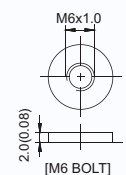

Terminal Hardware Initial Torque:
5.5Nm ±5%

Constant power discharge characteristics at 25 °C/77 °F Unit: W

Discharge Time F.V. (V/cell)	15 Min	30 Min	45 Min	1 Hr	2 Hr	3 Hr	4 Hr	5 Hr	8 Hr	10 Hr	20 Hr
1.90V	1355	1114	814	647.4	394.3	293.3	232.4	194.2	132.00	107.67	57.16
1.85V	1598	1226	889	719.9	434.1	320.5	254.2	211.6	142.82	117.05	62.18
1.80V	1806	1302	939	760.5	451.4	332.4	262.9	218.2	147.55	121.20	64.36
1.75V	1983	1351	971	778.6	459.9	336.7	267.3	222.5	150.00	122.40	65.45
1.70V	2123	1381	990	791.5	464.3	340.0	269.5	223.6	150.00	122.40	65.45
1.65V	2216	1401	1003	802.2	468.5	343.3	271.6	224.7	150.00	122.40	65.45
1.60V	2238	1415	1012	807.0	470.4	344.3	272.2	225.1	151.81	123.38	65.72

Constant current discharge characteristics at 25 °C/77 °F Unit: A

Discharge Time F.V. (V/cell)	15 Min	30 Min	45 Min	1 Hr	2 Hr	3 Hr	4 Hr	5 Hr	8 Hr	10 Hr	20 Hr
1.90V	114.4	92.9	67.8	55.09	33.27	24.55	19.36	16.18	11.00	8.97	4.76
1.85V	135.2	103.2	74.6	61.27	36.64	26.82	21.18	17.64	11.90	9.75	5.18
1.80V	155.0	110.4	79.2	64.73	38.09	27.82	21.91	18.18	12.30	10.10	5.36
1.75V	173.3	114.5	81.9	66.27	38.82	28.18	22.27	18.55	12.50	10.20	5.45
1.70V	187.4	117.1	83.5	67.36	39.18	28.45	22.45	18.64	12.50	10.20	5.45
1.65V	196.0	118.8	84.6	68.27	39.55	28.73	22.64	18.73	12.50	10.20	5.45
1.60V	198.3	119.9	85.3	68.68	39.70	28.81	22.68	18.76	12.65	10.28	5.48

All data and artworks shall be changed without prior notice, BB reserves the right to explain and update the information contained herein.

For operation, please refer to the instruction from technical manual.

B/3 REV. May, 2021

Powered by **B.B. Tech(Changsha)Co., Ltd.**